

---

# 2 WAYS 1 KW ISOLATED POWER DIVIDER/ COMBINER VHAC10

---



- Input power: 2 x 500 W
- Output power: 1 kW
- Return loss port 1-2: -25 dB Tip
- Return loss port 3: -20 dB Tip
- Input connector: 2 X N Female
- Output connector: 7/16" Female
- Material: Treated aluminum box

# RETURN LOSS PORT 3

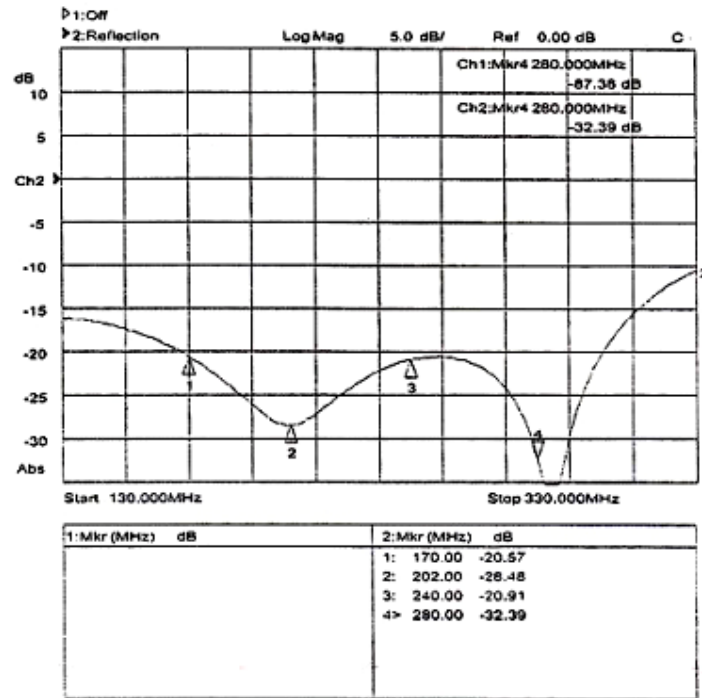

# ISOLATION

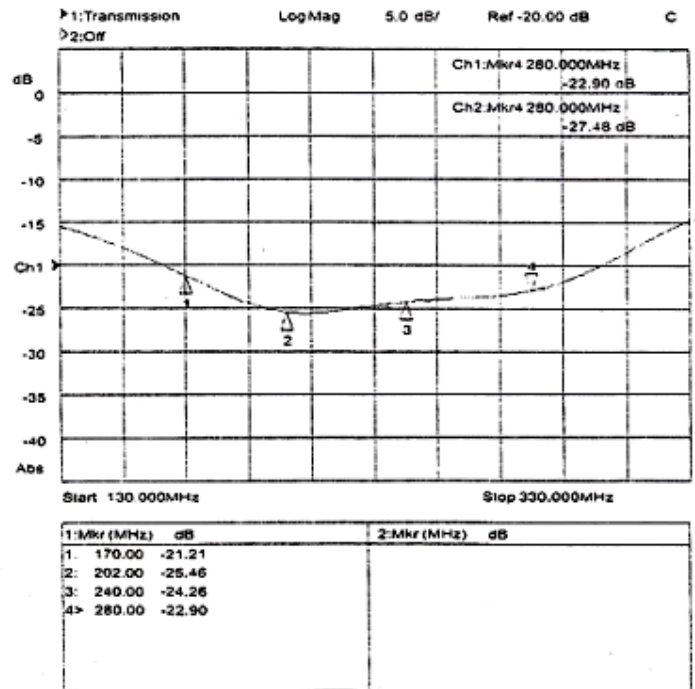

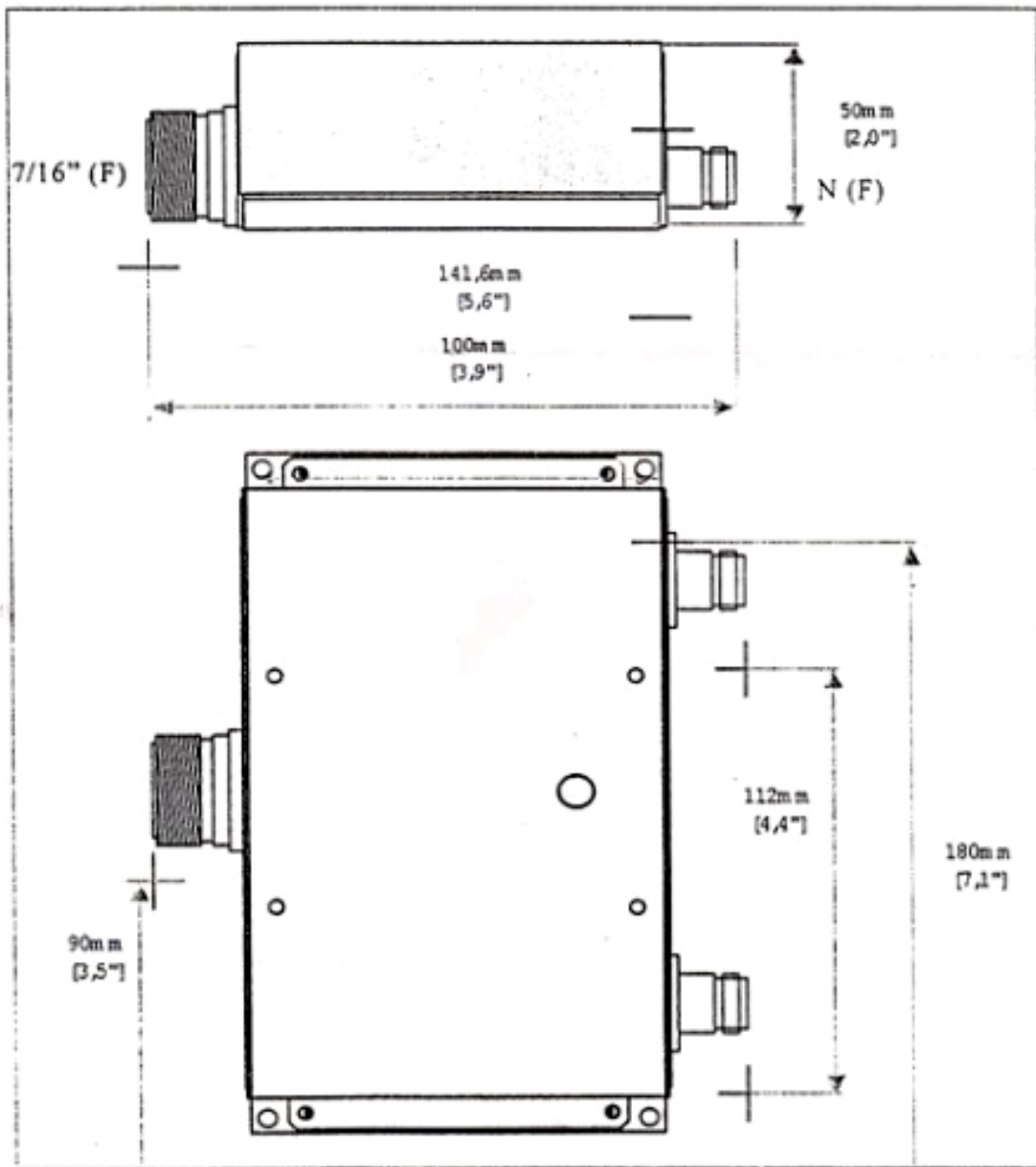

## HEATSINK MOUNTING/HARDWARE:

### 1. HEATSINK TOOLING

- Planarity: better than 0.03 mm
- Roughness: typical value 0.8

### 2. THERMAL COMPOUND

- Paste with silicones
- Thickness: optimum between 0.06 mm and 0.15 mm, on the whole back surface of the device.

### 3. SCREWS

- M4 or 6/32 UNC.

### 4. WASHERS

- Split lock washers WZ Ø4 + Flat washers ZU Ø4

### 5. TIGHTENING ORDER

- See next figure:

